

# Technical Bulletin



Present Glue



Future Glue

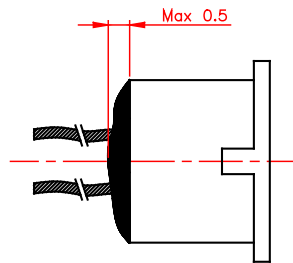

CS 43/44/45 Socket  
Reinforcement on Backside of Socket

## CS Sockets Change of Glue

Sulse is pleased to announce that we have changed the glue on the backside of our CS Sockets. This means that the visual appearance changes into the color red.

The new glue, which is used as reinforcement on the backside of the CS Socket to make the sockets more robust, has improved manufacturing properties with respect to processing, consequently, targeting a more uniform quality level.

The new glue type has been qualified according to our internal procedures. The test report is available and can be provided upon request.

The change will not have any influence on part numbers or ordering procedures.

Should you have any questions or need further information, please do not hesitate to contact our sales representative in your area.

Dan Lundahl  
Quality Manager  
Medical Division