

Description

Miniature magnetic receiver (balanced armature type) for use in hearing aids.



Features

- Ideal for ITE and BTE applications
- Specifically designed for digital applications
- ½ the size of a 3300 and 1900 receivers
- Broadband output
- Zero bias configurations

Dimensions in mm (inch)

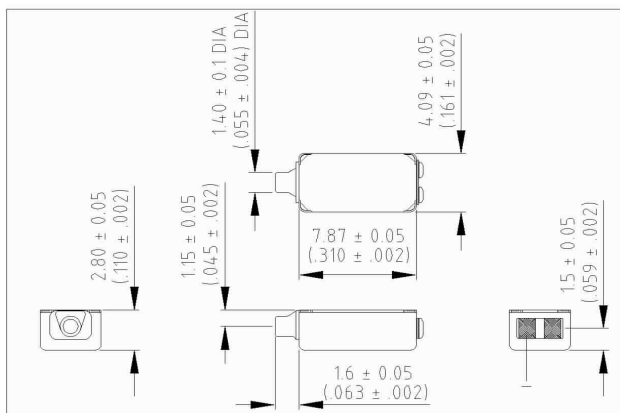

Mechanical Data

| | |
|--------------------|--------------------------|
| Weight | 0.31 gr. |
| Case material | Ni80Fe15Mo5 |
| Solder pad content | Sn96.5Ag3.0Cu0.5 |
| Dimensions | Refer to outline drawing |

Typical response curve

Refer to specifications section for measurement conditions.



Sonion reserves the right to make changes at any time to improve reliability, function or design, in order to provide the best product possible. Receivers series of this type can produce very high sound pressure levels. When such receivers are applied in hearing instruments or other communications equipment special attention should be paid to this capacity in order to prevent possible hearing damage.

Data Sheet



receiver 32A010

3320 - 3015115
Version:1 06-OCT-2008

Specifications

Acoustic loading: 10.0 mm of 1.0 mm diameter tubing into a 2 cc coupler.
Drive is voltage drive of 0.15 V RMS (0.35 mA @ 500 Hz) unless specified otherwise.
Environmental conditions: 23 °C (73.4F), 50 % RH

| Acoustic parameters | | Min | Typ | Max | Unit | Comments |
|---------------------------------|------------|-------|-------|-------|------|---------------|
| Sensitivity | @ 200 Hz | 102.5 | 105.5 | 108.5 | dB | |
| | @ 300 Hz | 102 | 105 | 108 | dB | |
| | @ 500 Hz | 101.5 | 104.5 | 107.5 | dB | |
| Peak 1 | frequency | 1900 | 2150 | 2400 | Hz | |
| | output | 107 | 109.5 | 112 | dB | |
| Valley 1 | frequency | 3900 | 4150 | 4400 | Hz | |
| | output | 90.5 | 93.5 | | dB | |
| Peak 2 | frequency | 5025 | 5225 | 5425 | Hz | |
| | output | 97.5 | 100.5 | 103.5 | dB | |
| Valley 2 | frequency | 8300 | 8700 | 9100 | Hz | |
| | output | 68 | 71 | | dB | |
| THD | @ 1/3 peak | | | 5 | % | |
| | @ 1/2 peak | | | 5 | % | |
| Maximum output @ peak frequency | | | 125 | | dB | 100 mVA input |

| Electric parameters | | Min | Typ | Max | Unit | Comments |
|-----------------------|--|-----|-----|-----|------|----------|
| Impedance @ 1000 Hz | | 81 | 101 | 121 | Ohm | |
| Impedance @ 500 Hz | | 53 | 66 | 79 | Ohm | |
| DC resistance @ 20 °C | | 42 | 50 | 58 | Ohm | |
| DC bias current range | | | | | | |

| Additional parameters | | Min | Typ | Max | Unit | Comments |
|---------------------------|--|-------|-----|-----|------|---|
| Shock resistance | | 12000 | | | g | 90% survival rate with THD @ 1/2 peak freq. < 10% |
| Storage temperature range | | -40 | | 63 | °C | |

A positive voltage applied to the negative terminal (-) will result in an increase in pressure at the sound outlet.

Sonion reserves the right to make changes at any time to improve reliability, function or design, in order to provide the best product possible.
Receivers series of this type can produce very high sound pressure levels. When such receivers are applied in hearing instruments or other communications equipment special attention should be paid to this capacity in order to prevent possible hearing damage.

THD vs Frequency, typical, nominal input

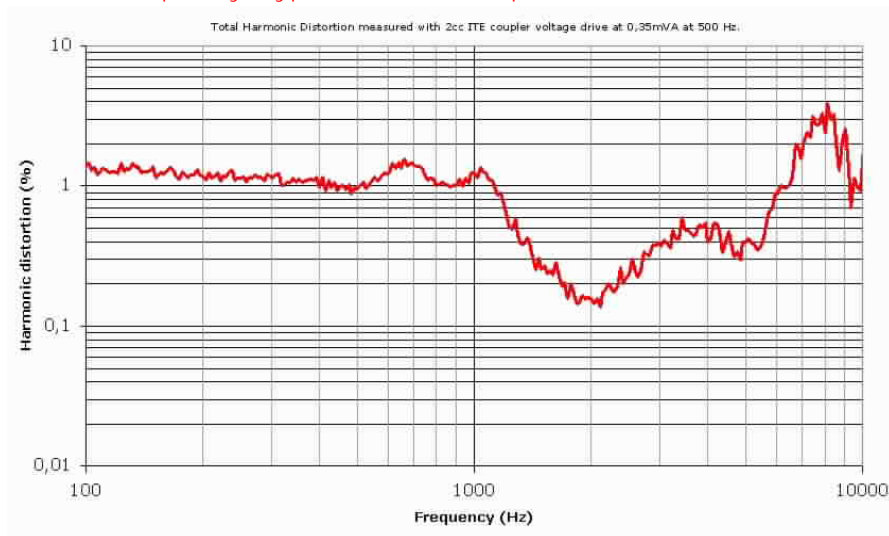

Sonion reserves the right to make changes at any time to improve reliability, function or design, in order to provide the best product possible. Receivers series of this type can produce very high sound pressure levels. When such receivers are applied in hearing instruments or other communications equipment special attention should be paid to this capacity in order to prevent possible hearing damage.